

You have decided to buy a watch, which was assembled by a watchmaker using a Ronda movement. Please note that no watches are produced or distributed under the Ronda Brand.

In case of repairs, guarantee claims and questions concerning the functioning of a watch, purchasers and consumers should contact their retailer or the watch manufacturer, for which the relevant information can be found in the sales or guarantee documentation provided with the watch.

**Description of the display and control buttons**

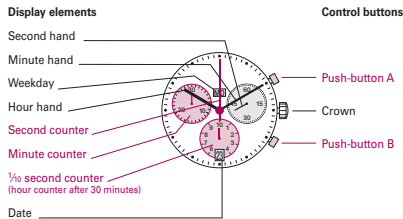

01

**Setting the time**

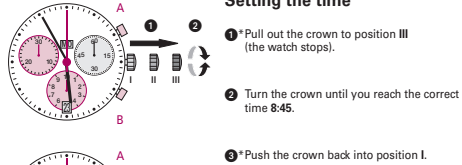

**Please note**  
\* In order to set the time to the exact second, 1 must be pulled out when the second hand is in position «60». Once the hour and minute hands have been set, 3 must be pushed back into position I at the exact second.

02

**Setting the date (quick mode)**

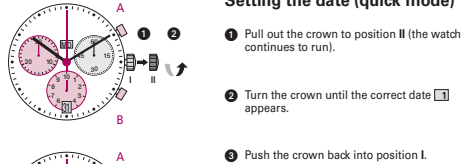

**Please note**  
The date can be changed during the date changing phase between approx. 9:00 PM and 12:00 PM; please note that the date must be set to the date of the following day as in this case the automatic date changing does not occur at midnight.

03

**Setting the date, weekday and time**

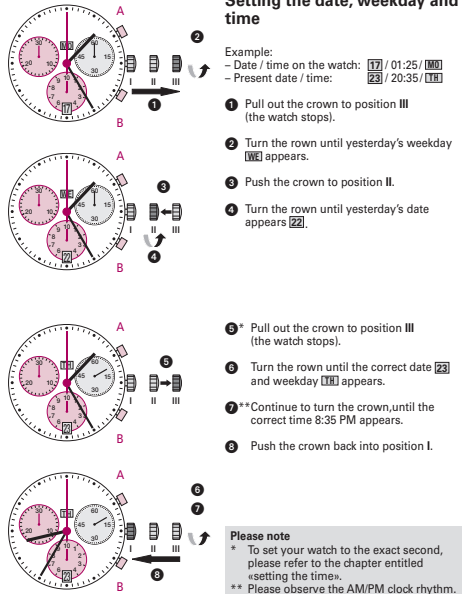

04

**Chronograph: Basic function**

(Start / Stop / Reset)

Example:

- 1 Start: Press push-button A.
- 2 Stop: to stop the timing, press push-button A once more and read the chronograph counters: 4 min / 38 sek / 1/2 sec
- 3 Zero positioning: Press push-button B. (The chronograph hands will be reset to their zero positions.)

05

**Chronograph: Accumulated timing**

Example:

- 1 Start: (start timing)
- 2 Stop: (e.g. 15 min 5 sec following 1)
- 3 Restart: (timing is resumed)
- 4 Stop: (e.g. 5 min 12 sec following 3) = 20 min 17 sec (The accumulated measured time is shown)
- 5 Reset: The chronograph hands are returned to their zero positions.

**Please note**  
\* Following 4, the accumulation of the timing can be continued by pressing push-button A (Restart / Stop, Restart / Stop, ...).

06

**Chronograph: Intermediate or interval timing**

Example:

- 1 Start: (start timing)
- 2 Display interval: e.g. 20 minutes 17 seconds (timing continues in the background)
- 3 Making up the measured time: (The chronograph hands are quickly advanced to the ongoing measured time.)
- 4 Stop: (Final time is displayed)
- 5 Reset: The chronograph hands are returned to their zero position

**Please note**  
\* Following 3, further intervals or intermediates can be displayed by pressing push-button B (display interval / make up measured time, ...).

07

**Adjusting the chronograph hands to zero position**

Example:  
One or several chronograph hands are not in their correct zero positions and have to be adjusted (e.g. following a battery change).

- 1 Pull out the crown to position III (all chronograph hands are in their correct or incorrect zero position).
- 2 Keep push-buttons A and B depressed simultaneously for at least 2 seconds (the second counter hand rotates by 360° → corrective mode is activated).

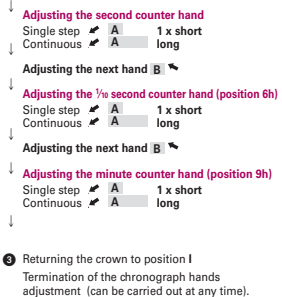

08

